

TRF 2X2 - Troffer *with Acrylic Lens*

Application

The TRF series 2X2 troffer is an economical and efficient design for quality lighting in commercial and retail applications. Long recognized as a standard in luminaires, the acrylic lens luminaire offers low cost maintenance with exceptional light output. For use in grid ceiling (NEMA Type G). Available in 2, 3 and 4 lamp T5 or T8 configurations.

Construction

Fixture housing and ends are constructed from die formed steel, embossed for strength and uniformity. The heavy-duty ends attach to housing with tabs and screws. Fixture has integral EQ clips. Quick access plate for convenient power connections. All painted metal parts are pre-treated with a phosphate bonding process and painted with electrostatically applied high temperature baked white enamel for superior quality and durability.

Reflectors are constructed from highest quality specular on polished or white aluminum. Material form, fit and thickness meet or exceed all UL 1598 requirements. Computer assisted design provides maximum light output, uniform light distribution, rigid strength and ballast access without the use of tools. The durable surface is highly resistant to scratching and non-abrasive cleaning solutions, making the reflectors easy to clean.

Electrical

Energy saving and electronic Class P, CBM/ETL certified HPF ballast comply with Federal Energy Efficiency Standards; Underwriters Laboratories listed.

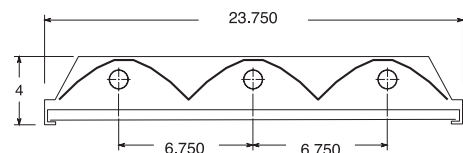
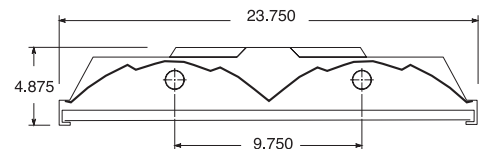
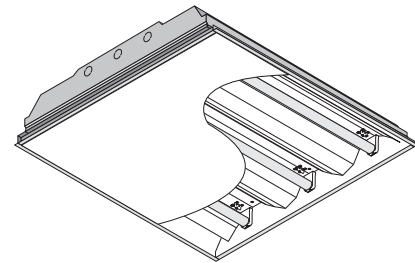
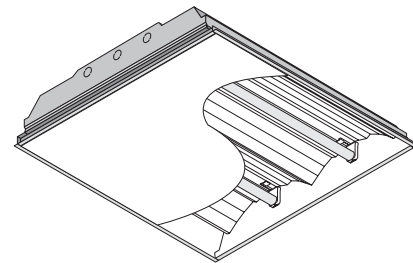

Industry Leaders in Customization + Lead Times for Over 25 Years



TRF 2X2 - Photometrics

reflect-a-light™

Coefficients of Utilization-Zonal Cavity Method Effective Floor Cavity Reflectance 0.20											
RC	80%				70%				50%		
RW	70%	50%	30%	10%	70%	50%	30%	10%	50%	30%	10%
0	96	96	96	96	94	94	94	94	89	89	89
1	89	86	84	81	87	85	82	80	81	79	77
2	83	78	73	70	81	76	72	69	74	70	67
3	77	70	65	61	75	69	64	60	67	63	59
4	72	64	58	53	70	63	57	53	61	56	52
5	66	58	51	47	65	57	51	47	55	50	46
6	62	53	46	42	60	52	46	42	50	45	41
7	58	48	42	37	56	47	41	37	46	41	37
8	53	43	37	33	52	43	37	33	42	36	33
9	49	39	33	29	48	39	33	29	38	33	29
10	46	36	30	26	45	36	30	26	35	30	26

Plane: 0-DEG 90-DEG
 Spacing Criteria: 1.1 0.9
 Efficiency: 83.2%
 Photometric Certified by: Luminaire Testing Laboratory
 Report No.: LTL1311

Catalog Number:
TRF-21722-SA-N

Lamps:
Two F17T8

Ballast:
Electronic 2-F32IS

Coefficients of Utilization-Zonal Cavity Method Effective Floor Cavity Reflectance 0.20											
RC	80%				70%				50%		
RW	70%	50%	30%	10%	70%	50%	30%	10%	50%	30%	10%
0	87	87	87	87	85	85	85	85	81	81	81
1	81	78	76	74	79	77	75	72	74	72	70
2	76	71	67	63	74	69	66	62	67	64	61
3	70	64	59	55	69	63	58	54	61	57	54
4	65	58	52	48	64	57	52	48	55	51	47
5	60	52	46	42	59	51	46	42	50	45	42
6	56	48	42	38	55	47	41	37	46	41	37
7	52	43	37	33	51	43	37	33	42	37	33
8	48	39	33	30	47	39	33	29	38	33	29
9	45	35	30	26	44	35	30	26	34	29	26
10	42	32	27	23	41	32	27	23	31	26	23

Plane: 0-DEG 90-DEG
 Spacing Criteria: 1.2 1.1
 Efficiency: 83.3%
 Photometric Certified by: Luminaire Testing Laboratory
 Report No.: LTL3675

Catalog Number:
TRF-31722-SA-N

Lamps:
Three F17T8

Ballast:
Electronic 3-F32IS

Fixture Ordering Guide

TRF Series	2 Lamps	17 Wattage	22 Length x Width	EA Material	N Ballast
---------------	------------	---------------	----------------------	----------------	--------------

Troffer Series TRF - Acrylic Lens	Lamp Wattage 14 - 14 Watt T5 17 - 17 Watt T8 24 - 24 Watt T5 40 - 40 Watt T5 55 - 55 Watt T5	Fixture Size (Length x Width) 22 - 2x2	Material Type EA - 95% Enhanced Aluminum SA - 86% Specular Aluminum WA - 91% White Aluminum MA - 93% Micro Aluminum	Electronic Ballast Options H - High Power N - Normal Power L - Low Power 4 - 480 Volt
No. of Lamps 2 - Two Lamps 3 - Three Lamps 4 - Four lamps				

Download catalog PDF's, IES files and cutsheets on our website.



www.usenergysciences.com
1.800.537.1629

US Energy Sciences
reflecting technology™